

Fachadas Ventiladas com painéis Viroc - Estrutura de Alumínio

Parafusos e rebites para fixação dos painéis Viroc

Painéis de 12 mm de espessura

DRILLNOX STAR TB 5.5x50 W16

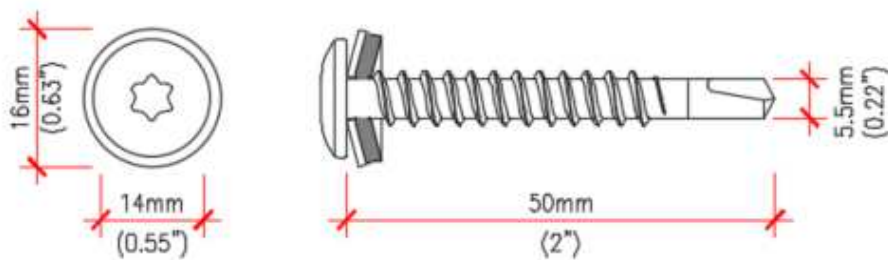

STARZAC/2C 5.5x38 W16

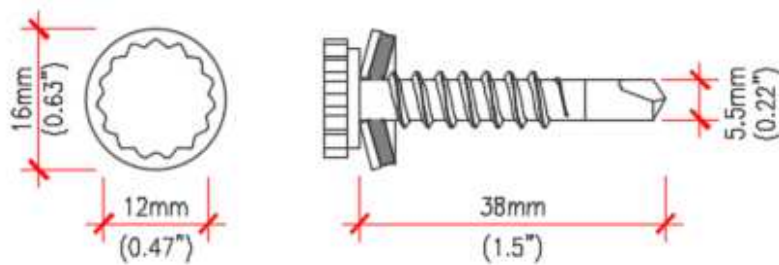

Rebite AL/In A2 N.E 4.8x18 CEL16 e RIVCOLOR AL/In N.E 4.8x18 CEL

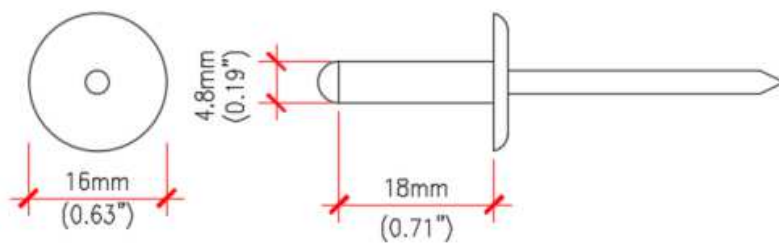

Acessório: Riveter Nose, utilização obrigatória

Painéis de 16mm de espessura

DRILLNOX STAR TB 5.5x50 W16

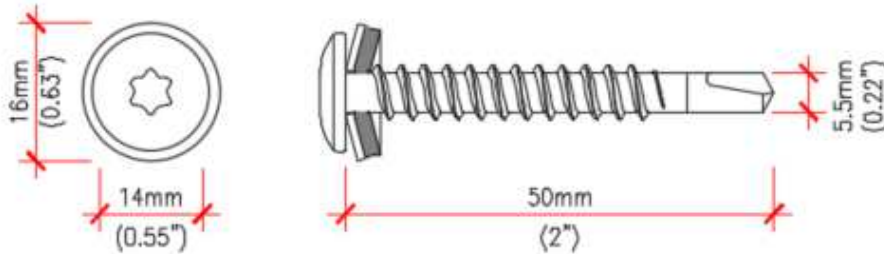

STARZAC/2C 6.3x50 W16

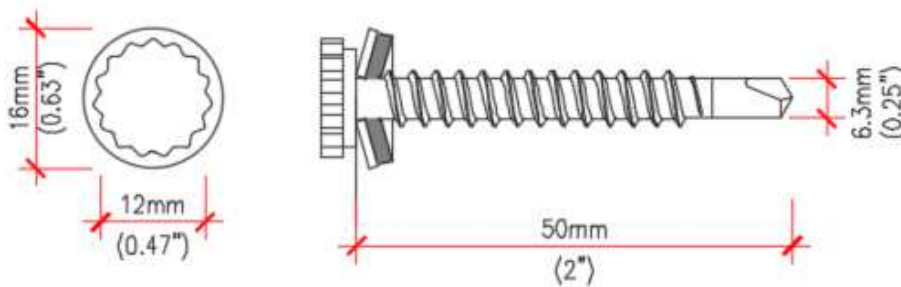

Rebite AL/In A2 N.E 4.8x22 CEL16 e RIVCOLOR AL/In N.E 4.8x22 CEL

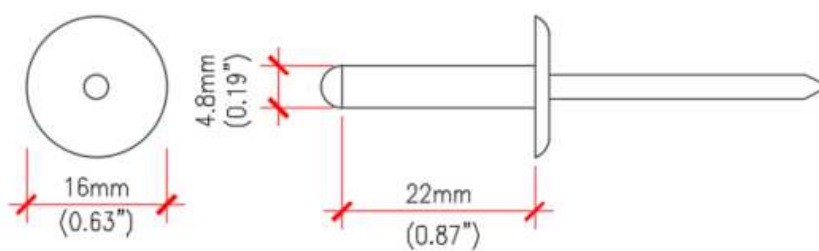

Acessório: Riveter Nose, utilização obrigatória

Riveter Nose



RIVETER NOSE			
For riveter	Thread length.	Pack.	Code
<b>ACCUBIRD</b>	8	1	611 111
<b>LR 5 - LR 20</b>	13	1	611 110

Estrutura de suporte

Esquadros

Clip Bracket com 80 mm



Aluminium 6063 T66  
+ Polyamide PA06 chargé de fibre  
de verre de couleur bleue

Équerre ISOLALU+ LR 80  
+ Cale THERMOSTOP

L	Ep. semelle	Dn <sub>mini</sub>	Dn <sub>maxi</sub>	Cond.	Code
40	3	70	70	100	610 100
60	3	90	90	100	610 102
80	3	90	110	100	610 104
100	3	110	130	100	610 106
120	3	130	150	100	610 108
140	3	150	170	50	610 110
160	4	170	190	50	610 112
180	4	190	210	50	610 114
200	4	210	230	50	610 116
220	4	230	250	50	610 118
240	4	250	270	50	610 120
260	4	270	290	50	610 122
280	4	290	310	50	610 124
300	4	310	330	50	610 126

Clip Bracket com 150 mm



Aluminium 6063 T66  
+ Polyamide PA06 chargé de fibre  
de verre de couleur bleue

Équerre ISOLALU+ LR 150  
+ Cale THERMOSTOP

L	Ep. semelle	Dn <sub>mini</sub>	Dn <sub>maxi</sub>	Cond.	Code
40	3	70	70	100	610 300
60	3	90	90	100	610 302
80	3	90	110	100	610 304
100	3	110	130	100	610 306
120	3	130	150	100	610 308
140	3	150	170	50	610 310

Ancoragem (esquadro-suporte)

MARCOVIS FM-X5 TF TX/SS A4 (1 un/esquadro)

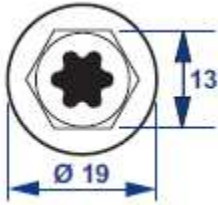

• Load: Up to 138 Kg

Polyamide PA6  
+ Screw in Carbon steel class 5.8  
zinc plated  $\geq 5 \mu\text{m}$

Polyamide PA6  
+ Austenitic stainless steel  
screw A4 - 50

**MARCOVIS FM-X5  
TF TX**

**MARCOVIS FM-X5  
TF TX / SS A4**

$\varnothing$	$t_m$	x	l	d	Screw $l_s$	$d_0$	$h_1$	Pack.	Code	Pack.	Code
8	10	x	80	6	85	8	80	100	360 500	100	360 550
8	30	x	100	6	105	8	80	50	360 502	50	360 552
8	50	x	120	6	125	8	80	50	360 504	50	360 554
8	80	x	150	6	155	8	80	50	360 505	50	360 551
8	100	x	170	6	175	8	80	50	360 507	50	360 553
10	15	x	85	7	90	10	80	50	360 506	50	360 556
10	30	x	100	7	105	10	80	50	360 508	50	360 558
10	45	x	115	7	120	10	80	50	360 510	50	360 560
10	65	x	135	7	140	10	80	50	360 512	50	360 562
10	90	x	160	7	165	10	80	50	360 514	50	360 564
10	130	x	200	7	205	10	80	50	360 516	50	360 566
10	160	x	230	7	235	10	80	50	360 518	50	360 568

Perfis de alumínio T e L

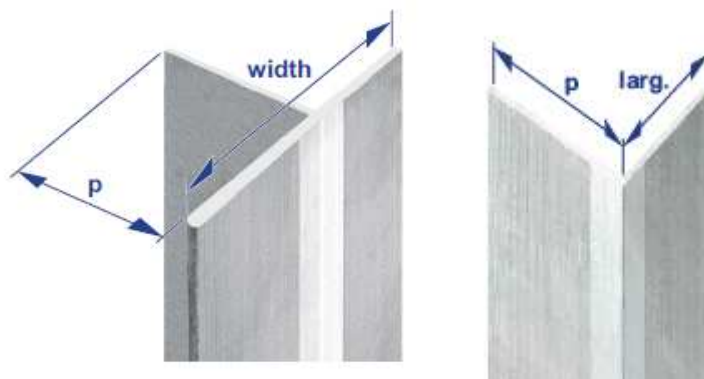

Perfil FACALU T 140x52x2 ou T 150x52x2,5

			Aluminium 6060 T5	
			FACALU PROFILE T	
width x p	Thick.	Lg, (m)	Pack.	Code
140 x 52	2	3	1	611 167
140 x 52	2	6	1	611 127
150 x 52	2,5	3	1	611 370
150 x 52	2,5	6	1	611 139

Perfil FACALU L 50x42x2, L 50x42x2.5 ou L 50x50x3

			Aluminium 6063 T66	
			FACALU PROFILE L	
width x p	Thick.	Lg, (m)	Pack.	Code
50 x 42	2	3	1	611 036
50 x 42	2	6	1	611 016
50 x 42	2,5	3	1	611 049
50 x 42	2,5	6	1	611 047
50 x 50	3	3	1	611 462
50 x 50	3	6	1	611 375

Parafusos (esquadro-perfil)

PERFIX TH In A2 5.5x25, (2 un/esquadro)



			Acier Inoxydable Austénitique A2 Aisi 304	
			PERFIX TH In A2	
$\emptyset$ x L	CP sur Alu	H	Cond.	Code
5,5 x 25	1,75 à 3	8	500	300 466

Rebite N.E – CL Alu-Inox 5x12



				Alliage Aluminium/ Acier inoxydable A2	
				RIVET N.E. - CL ALU-INOX	
$\emptyset$ x L	$d_w$	$S_{mini}$ / $S_{maxi}$	$d_0^*$	Cond.	Code
5 x 12	14	4 / 8	5,2	500	270 540

Bucha plástica (isolamento-suporte)

INCO Black

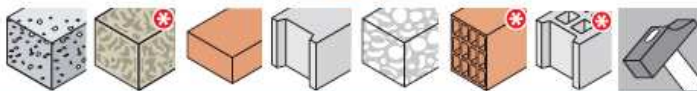
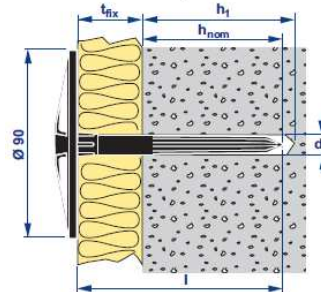

• Load: Up to 17 Kg



Black polypropylene

**INCO Black**

$\emptyset$ / $t_{fix}$ x $l$	$d_0^{\#}$	$h_1$	Pack.	Code
8 / 40 x 60	8	30	500	358 101
8 / 60 x 80	8	30	500	358 102
8 / 80 x 100	8	30	500	358 104
8 / 100 x 120	8	30	250	358 105
<hr/>				
10 / 40 x 70	10	40	500	358 170
10 / 60 x 90	10	40	500	358 172
10 / 80 x 110	10	40	250	358 174
10 / 110 x 140	10	40	200	358 176

Chave centradora, ML 1000



**DRILL CENTRING TOOL  
ML 1000**

Model	Pack.	Code
Centring tool ML 1000	1	284 000

## Perfis de angulo



Pre-painted Aluminium 1 mm thickness		
P.A.S. Al / PrL		
For panel thick. (mm)	Pack. (m) *	Code
10	30	611 700
15	30	611 702
20	30	611 704

(\*) Packaging: One 10 x 3 meters bundle, cannot be split

- Colours std.: RAL 1013 / 1015 / 7016 / 7035 / 9001 / 9007 / 9010 / 9016 - RAL Painting and other widths available on request
- Facade application:
  - Decorative corner profile



Pre-painted Aluminium 1 mm thickness		
P.A.R. Al / PrL		
For panel thick. (mm)	Pack. (m) *	Code
10	30	611 710
15	30	611 712
20	30	611 714

(\*) Packaging: One 10 x 3 meters bundle, cannot be split

- Colours std.: RAL 1013 / 1015 / 7016 / 7035 / 9001 / 9007 / 9010 / 9016 - RAL Painting and other widths available on request
- Facade application:
  - Decorative corner profile



## Banda adesiva

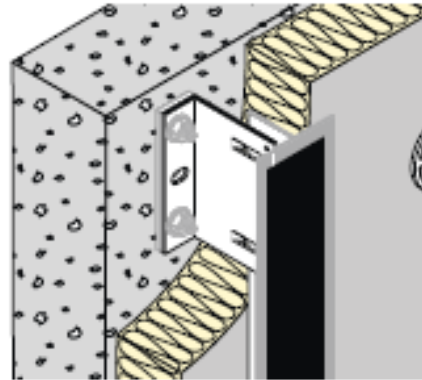

				Acrylic adhesive	
				ADHESIVE BAND	
Colour	Width	Roll lg. (ml)	No. rolls	Pack. (m)	Code
Black	40	10	6	60	611 750
Black	80	25	2	50	611 307
Black	100	25	2	50	611 319
Black	120	25	2	50	611 327

## Perfil anti-roedores

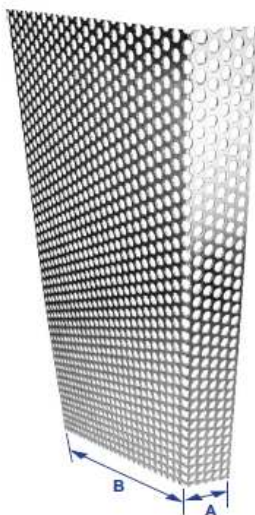

		Aluminium	
		RODENT-PROOF GRILLE	
		Alu	
A	B	Pack. (m)	Code
40	100	2,5	668 090
40	120	2,5	668 091
40	140	2,5	668 092
40	160	2,5	668 093
40	180	2,5	668 094
40	200	2,5	668 095
40	220	2,5	668 096
40	240	2,5	668 097

- Other widths available on request
- Facade application:
  - Start section for ventilated facade



Contactos para informação e fornecimento

Portugal

Tel: +351 912 110 413

Email: [pedro.durao.etanco@gmail.com](mailto:pedro.durao.etanco@gmail.com)

França

UK

T :+33 01 34 80 52 08

T :+44 179 256 19 11

Email : [export@etanco.fr](mailto:export@etanco.fr)

Email : [commercial.france@etanco.fr](mailto:commercial.france@etanco.fr)

Etanco Bélgica

Etanco Alemanha

T: +32 3 354 15 00

T: +49 27 39 47 99 64

Etanco Polonia

Etanco Roménia

Itália

T: + 48 55 24 22 926

T : +40 31 425 12 82

T :+39 04 327 479 11

T : +40 72 264 69 44

T :+39 02 990 480 62